

## 1. SM3414B Package outline drawing

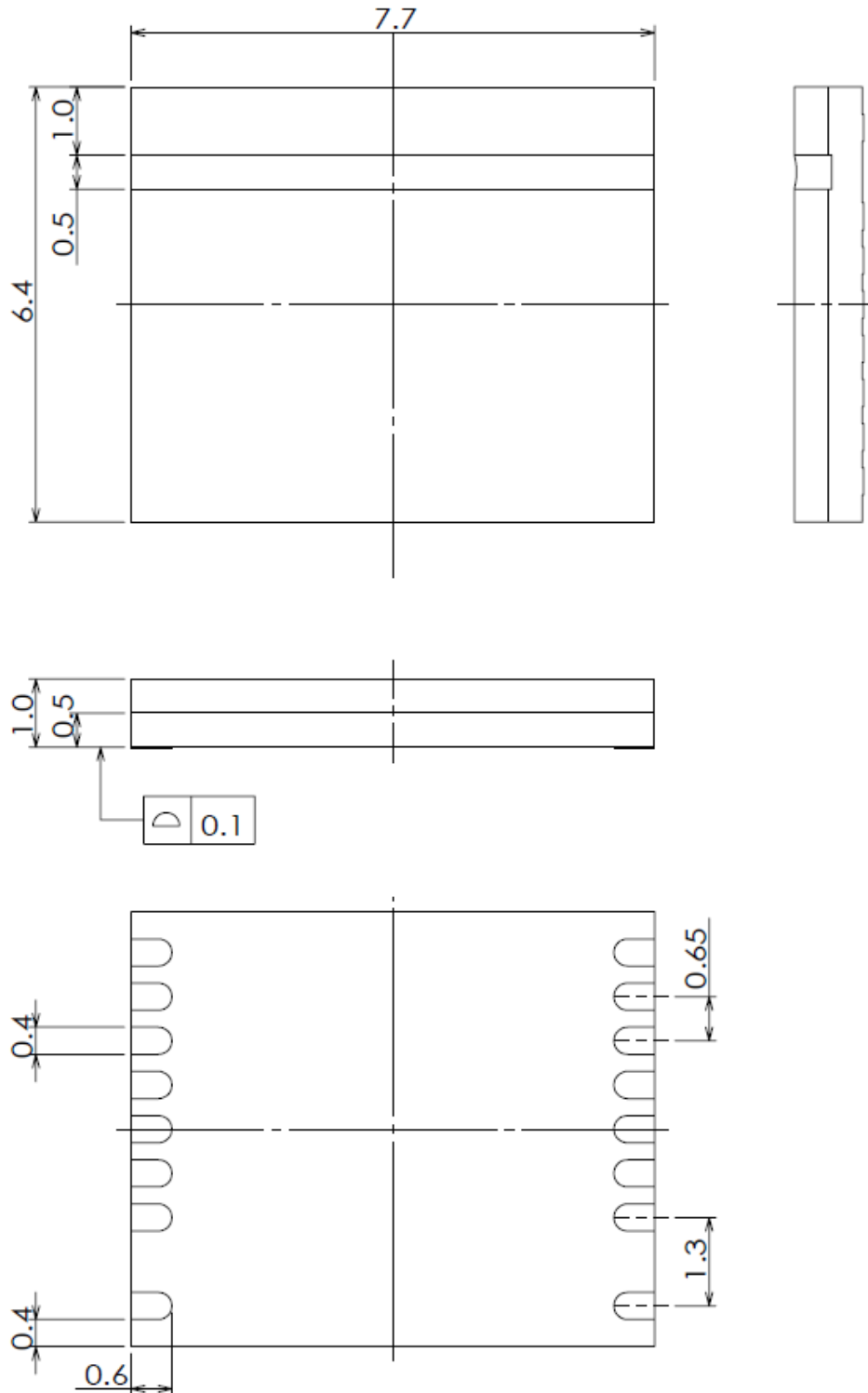

General tolerance :  $\pm 0.1$

## 2. Pin assignment

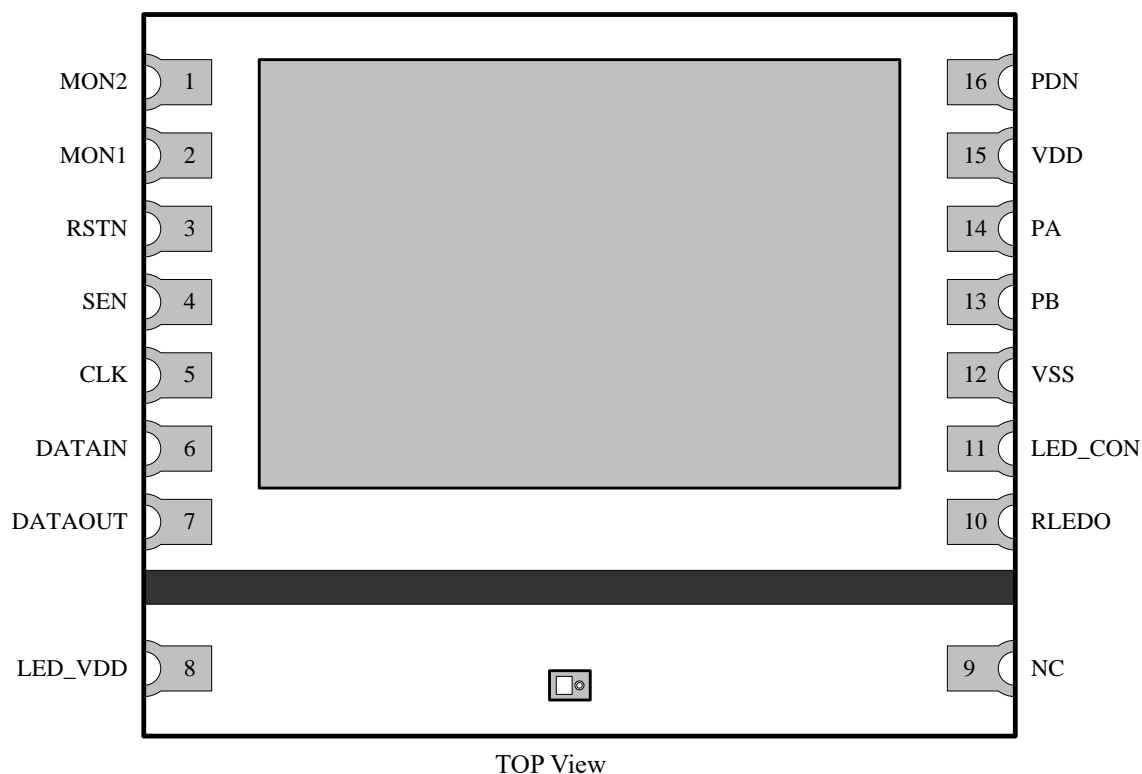

Pin No.	Name	I/O	Description
1	MON2	O	Internal signal monitor output pin 2
2	MON1	O	Internal signal monitor output pin 1
3	RSTN	I	Register reset and power-down pin (Pull-down pin, Active-Low)
4	SEN	I	Serial interface enable signal (Pull-up pin, Active-Low)
5	CLK	I	Serial interface clock signal input pin
6	DATAIN	I	Serial interface data input pin
7	DATAOUT	O	Serial interface data output pin
8	LED_VDD	S	LED power supply pin
9	NC	-	No connection
10	RLEDO	O	LED current control resistor connection pin
11	LED_CON	I	LED current adjustment pin
12	VSS	S	Ground pin
13	PB	O	Incremental signal phase B output pin
14	PA	O	Incremental signal phase A output pin
15	VDD	S	Power supply pin
16	PDN	I	Absolute function power-down pin (Pull-down pin, Active-Low)

[Type] I: Input pin, O: Output pin, S: Power supply pin

### 3. Recommended land pattern

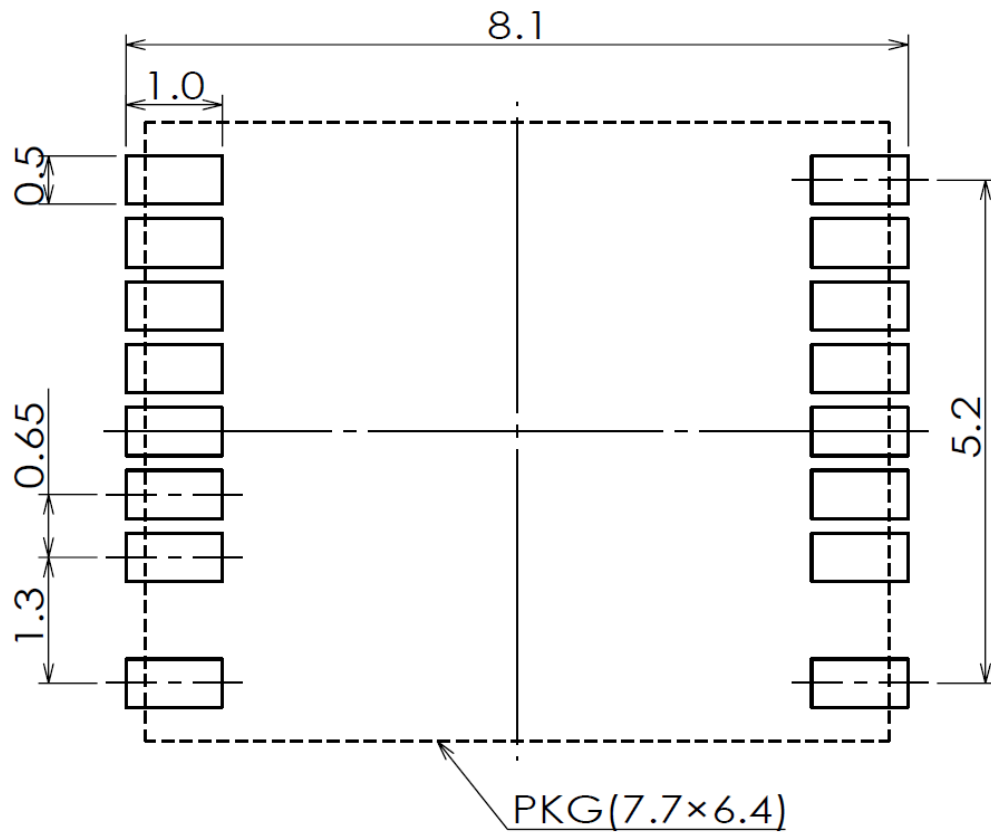

Unit : mm

General tolerance :  $\pm 0.1$

Please pay your attention to the following points at time of using the products shown in this document.

1. The products shown in this document (hereinafter "Products") are designed and manufactured to the generally accepted standards of reliability as expected for use in general electronic and electrical equipment, such as personal equipment, machine tools and measurement equipment. The Products are not designed and manufactured to be used in any other special equipment requiring extremely high level of reliability and safety, such as aerospace equipment, nuclear power control equipment, medical equipment, transportation equipment, disaster prevention equipment, security equipment. The Products are not designed and manufactured to be used for the apparatus that exerts harmful influence on the human lives due to the defects, failure or malfunction of the Products.  
If you wish to use the Products in that apparatus, please contact our sales section in advance.  
In the event that the Products are used in such apparatus without our prior approval, we assume no responsibility whatsoever for any damages resulting from the use of that apparatus.
2. NPC reserves the right to change the specifications of the Products in order to improve the characteristics or reliability thereof.
3. The information described in this document is presented only as a guide for using the Products. No responsibility is assumed by us for any infringements of patents or other rights of the third parties which may result from its use. No license is granted by implication or otherwise under any patents or other rights of the third parties. Then, we assume no responsibility whatsoever for any damages resulting from that infringements.
4. The constant of each circuit shown in this document is described as an example, and it is not guaranteed about its value of the mass production products.
5. In the case of that the Products in this document falls under the foreign exchange and foreign trade control law or other applicable laws and regulations, approval of the export to be based on those laws and regulations are necessary. Customers are requested appropriately take steps to obtain required permissions or approvals from appropriate government agencies.



SEIKO NPC CORPORATION

2-9-4, Taito, Taito-ku, Tokyo  
110-0016, Japan  
Telephone: +81-3-6747-5300  
Facsimile: +81-3-6747-5303  
<https://www.npc.co.jp/>  
Email: [sales@npc.co.jp](mailto:sales@npc.co.jp)